

1.Keypad User Guide

The keypad has number keys, function keys and a fingerprint reader. Enter correct passcode or scan your fingerprint on the fingerprint reader, and press a function key, if the passcode or the fingerprint is valid, the action of the function key will be performed.

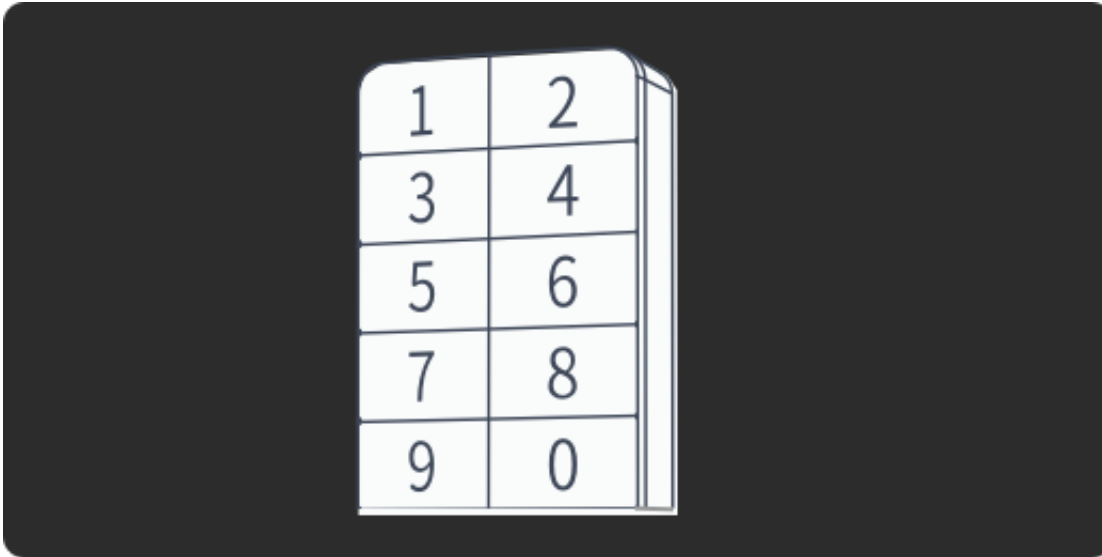

Enter correct passcode or scan your fingerprint on the fingerprint reader, and press the function key, the door will be unlocked.

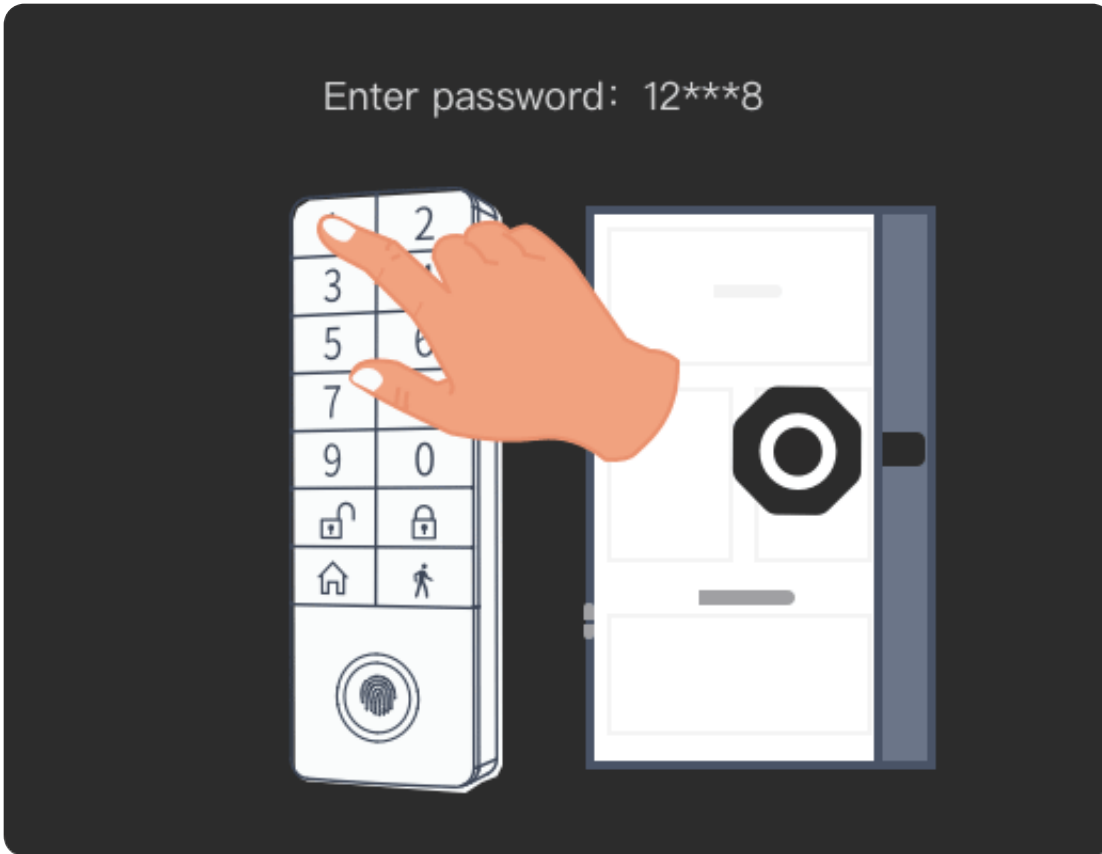

Press this function key, the door will be locked. Note: No need to enter passcode or scan your fingerprints before pressing this function key.

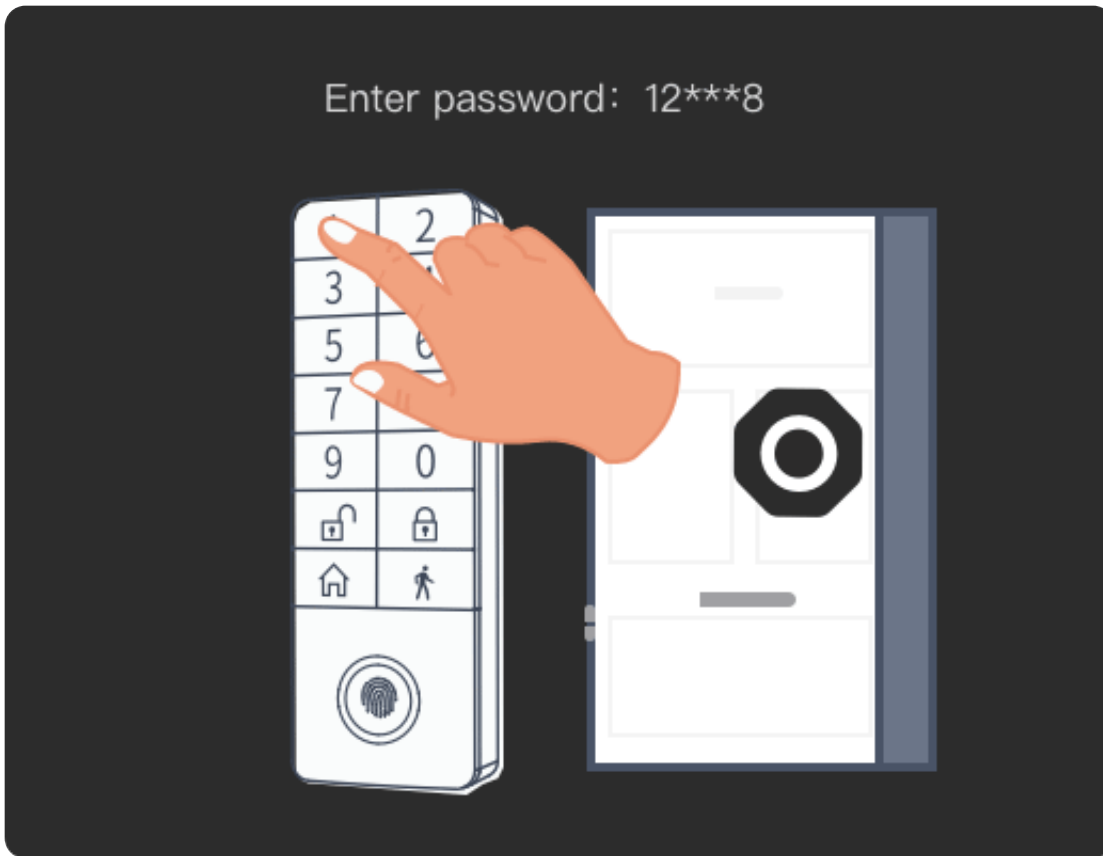

Unlock+Home/Disarmed

This function key is customizable, it can be set to Home mode or Disarmed mode. Enter correct passcode or scan your fingerprint on the fingerprint reader, and press the function key, the door will be unlocked and your security mode will be switched to the mode you set.(Home mode or Disarmed Mode)

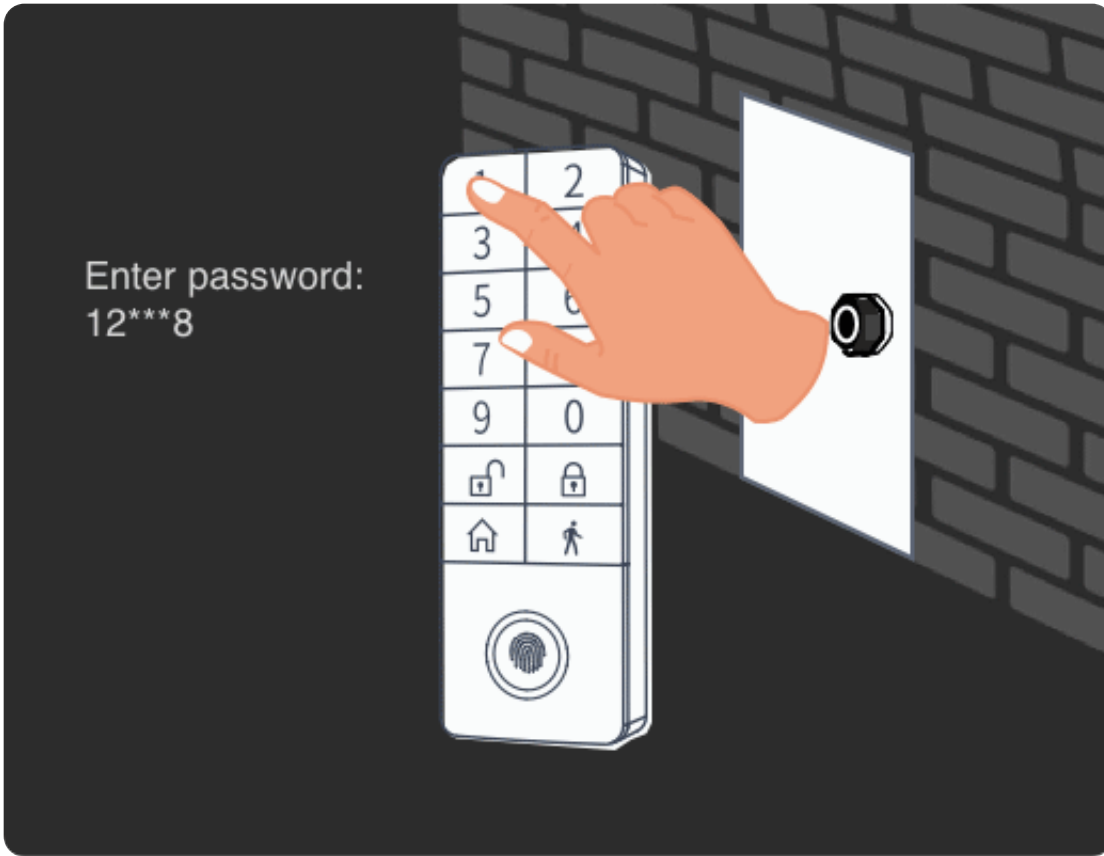

Lock+Away

Enter correct passcode or scan your fingerprint on the fingerprint reader, and press the function key, the door will be locked and your security mode will be switched to Away mode.

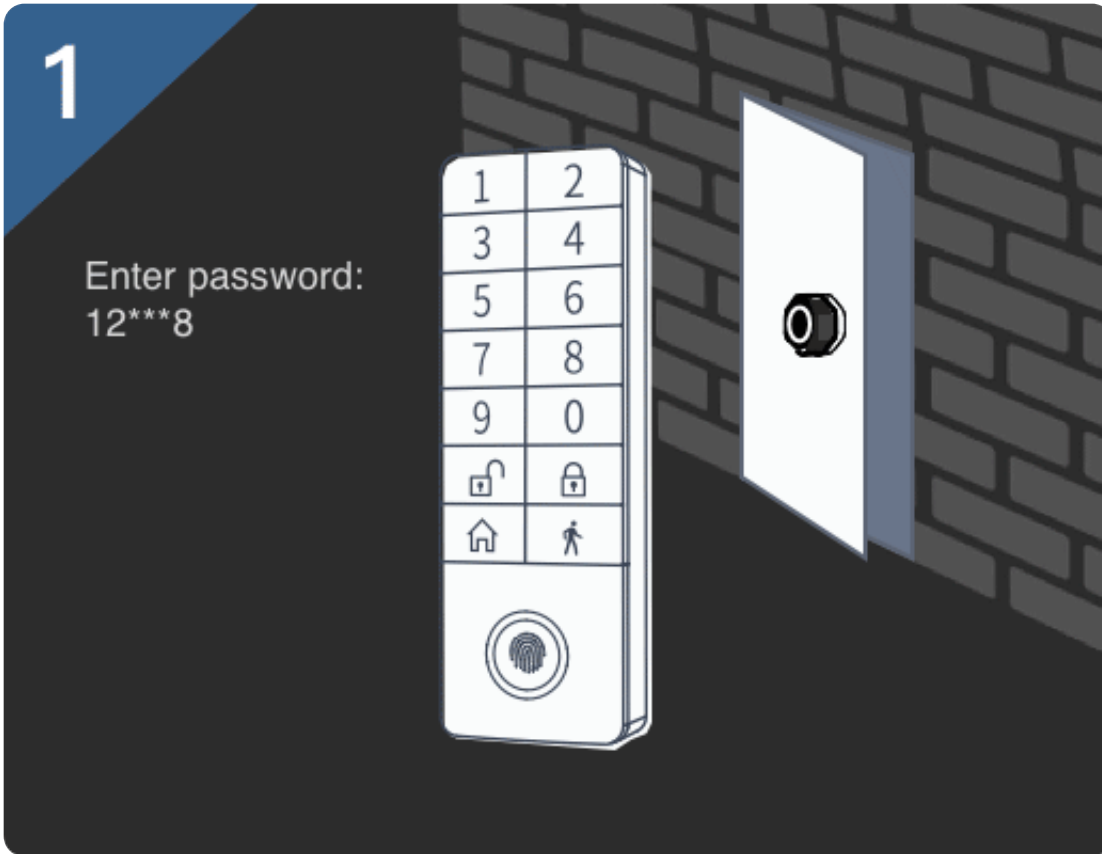

3.Number Keys

Set up a passcode to use passcode authentication for function keys. Enter a correct passcode, and press a function key, the corresponding action will be performed. For example, '123456' is added as a correct passcode. '123456' is entered on the device and the 'Unlock' key is pressed, the door will be unlocked and the device will flash blue light, then off; if an incorrect passcode is entered and press a function key, the device will flash red light. See below



4. Fingerprint Reader

Set up a fingerprint to use fingerprint authentication for function keys. Scan your finger on the fingerprint reader, if you see blue light on and hear "Didi" sound, fingerprint is accepted, the function keys are now enabled, press a function key, the corresponding action will be performed; if there is no blue light or "Didi" sound, the fingerprint is not accepted, scan your fingerprint again.

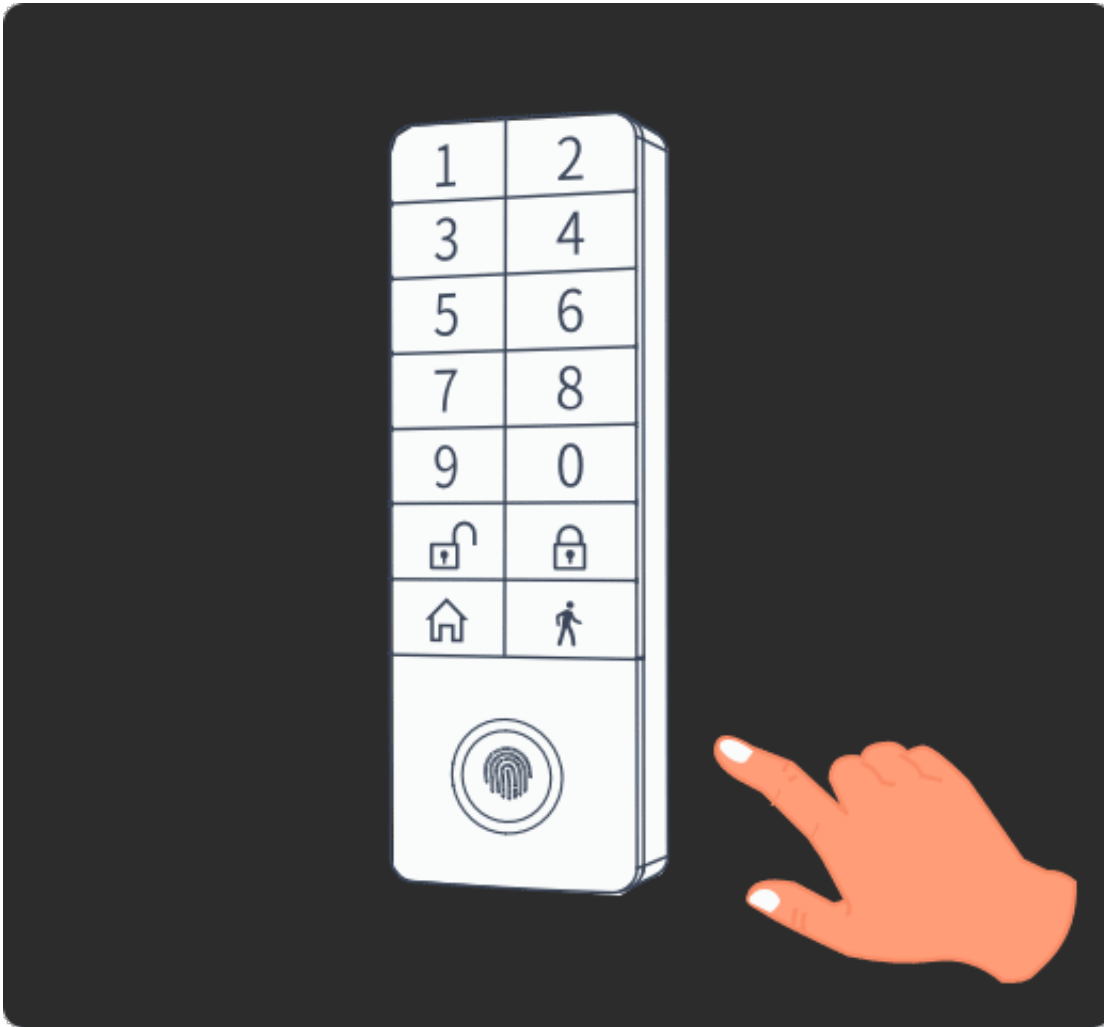

For further assistance, please contact us

Phone [1 \(800\) 976-0881](tel:18009760881)

Email support@bosmasmarthome.com

1. What is the Home key?

The Home key is one of the function key located on the bottom left corner, see below

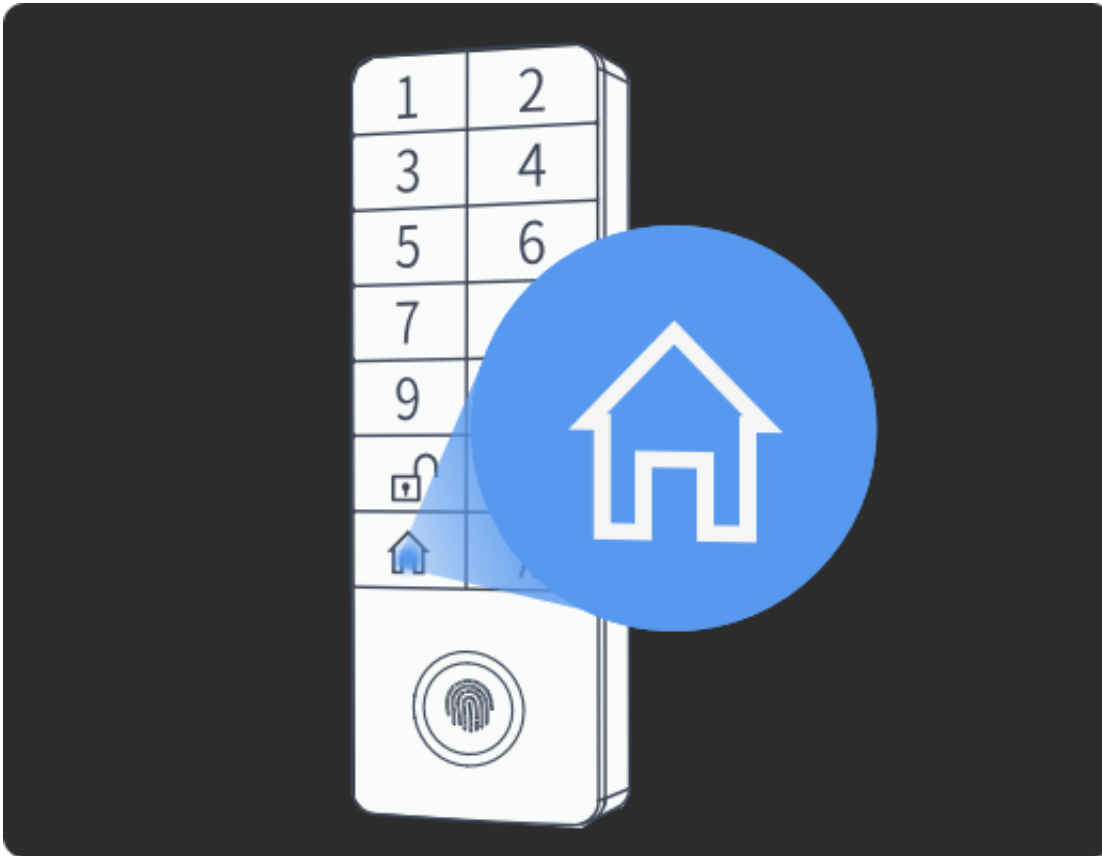

2. How to use the Home Key?

This function key is customizable, it can be set to Home mode or Disarmed mode. Enter correct passcode or scan your fingerprint on the fingerprint reader, and press the function key, the door will be unlocked and your security mode will be switched to the mode you set.(Home mode or Disarmed Mode)

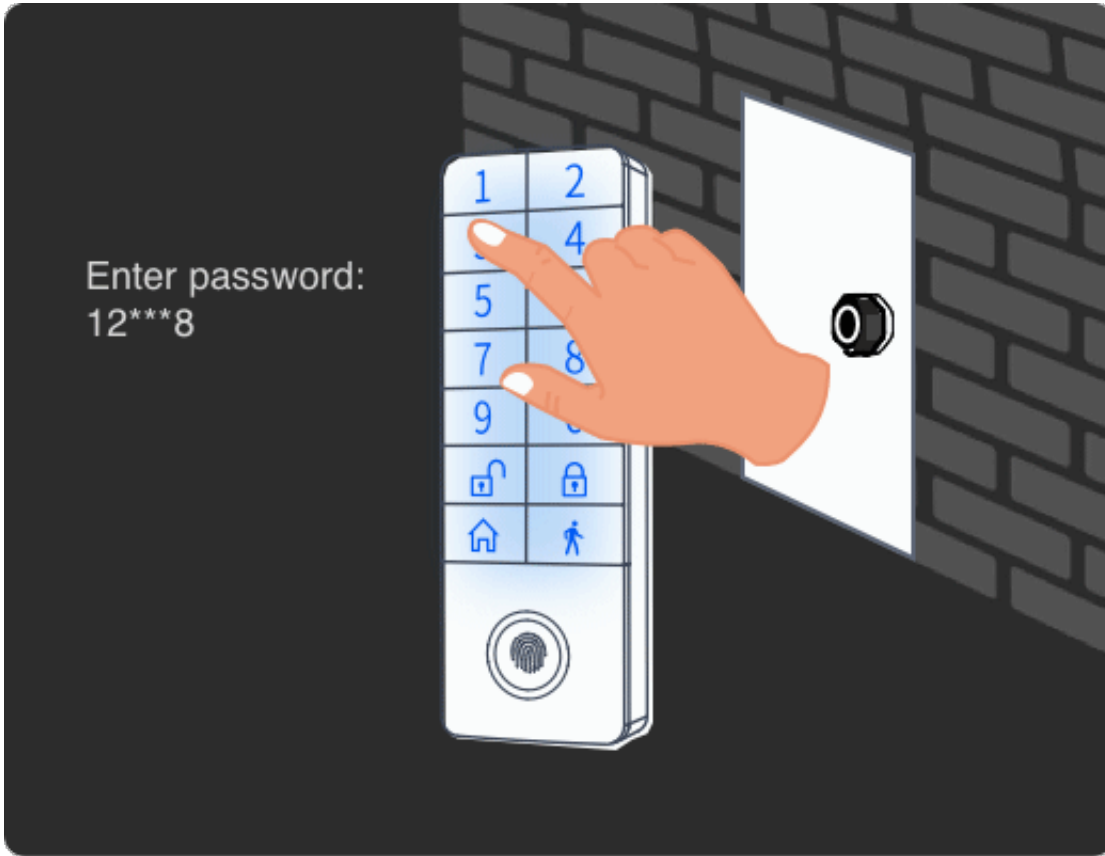

For further assistance, please contact us

Phone [1 \(800\) 976-0881](tel:18009760881)

Email support@bosmasmarthome.com

Device setup failure troubleshooting

1. Please make sure to press both the "Home" and "Away" buttons right above the fingerprint reader at the same time. If successful, you will see a flashing blue indicator light.

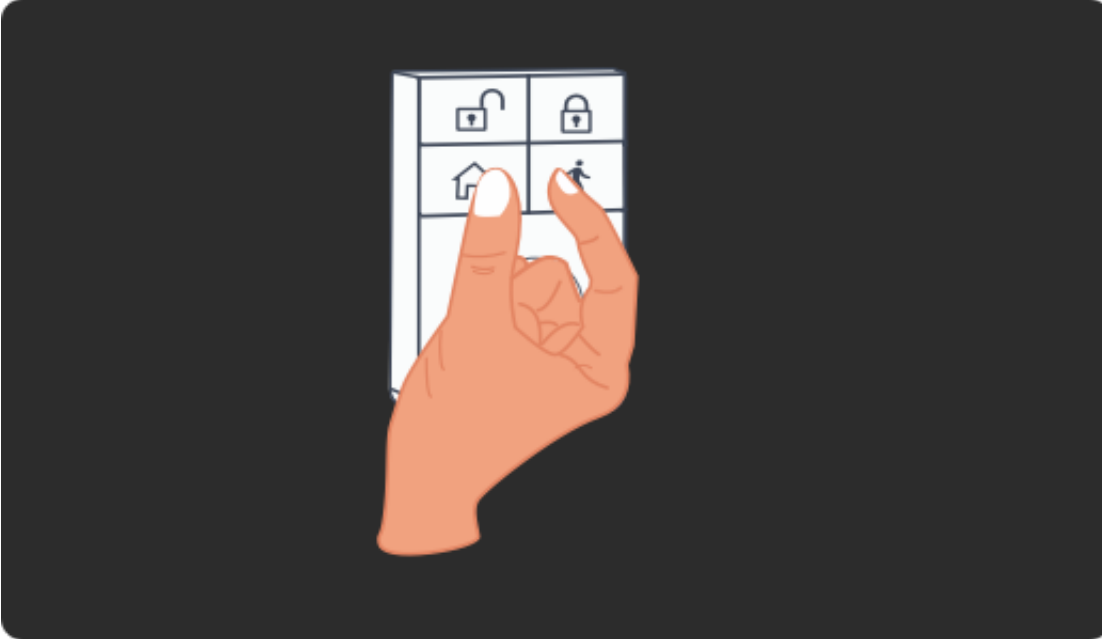

2. Please make sure that your phone is close to the keypad during the setup.

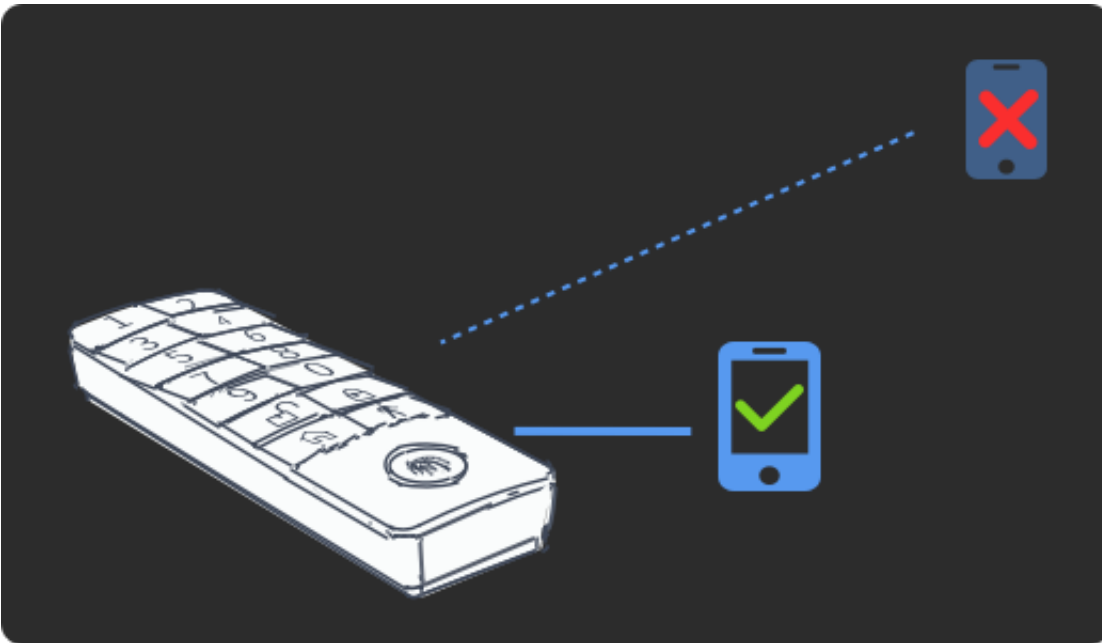

3. Please make sure that your phone's Bluetooth is enabled.



4. Please make sure that Gateway is already set up and connected to Wi-Fi.

For further assistance, please contact us

Phone [1 \(800\) 976-0881](tel:18009760881)

Email support@bosmasmarthome.com